

CATTLE STOCKYARD SYSTEMS

PROFESSIONAL DESIGNS FOR OPERATIONS OF ANY SIZE

Arrowquip employs a team of experts who are here to assist you with the stockyard design process from initial measurements straight through to installation. Whether you are using our designs or have an idea of your own you are working from, we can help you to optimize flow, minimize stress on your animals, and reduce the number of handlers required to work your livestock.

To find out more about our Stockyard Consultation Service, please contact 1800 814 107.

“

Our new yards have worked really, really well for what we're trying to achieve with our cattle. We're handling all of our stock very regularly. We are constantly monitoring weight gains and production, and the new yards have been fantastic for being able to easily manage the cattle and allow them to flow through from yards and from the main paddocks as well.

What we've found with the new yard system is it's been very easy to adapt to our own needs, and very easy to change as we go and try different scenarios. The scenario we've now got with the pound allows one person to easily draft the cows from the calves. It really becomes a one-person job for many of the situations now which is so different from the older yards.

”

*Sophie Campbell, “Yarrawonga”
Monaro Region, NSW*



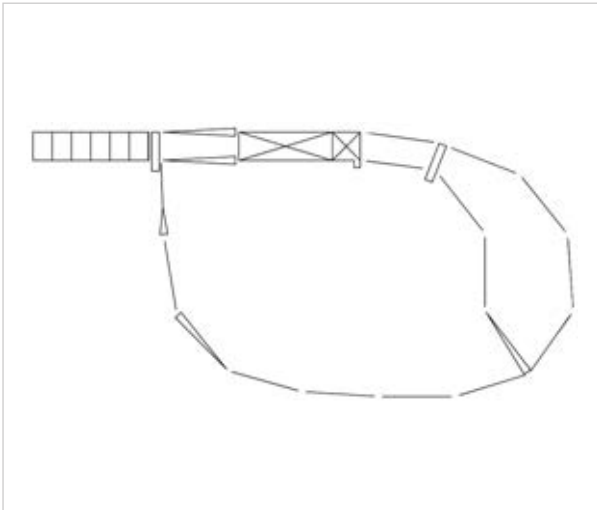

35 HEAD YARD

- 71m²
- 15.2m x 7.5m
- Traditional force
- 3-way draft gates
- 3.5m loading ramp

Product Code: AFQ33

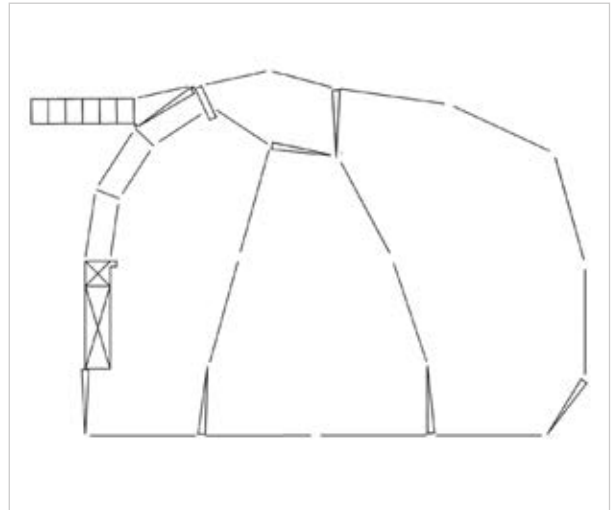

55 HEAD YARD

- 162m²
- 11.6m x 16m
- Traditional force
- 2-way draft gates
- 3.5m loading ramp

Product Code: AFQ76

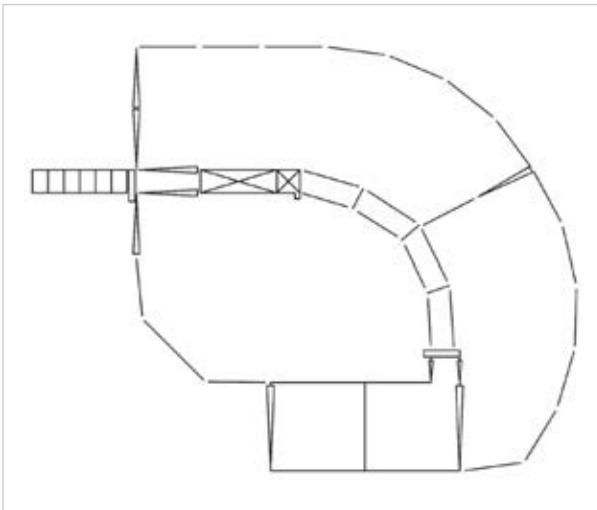

80 HEAD YARD

- 182m²
- 4.7m x 15.2m
- Beef Buddy®
- 3-way draft gates
- 3.5m loading ramp

Product Code: AFQ91

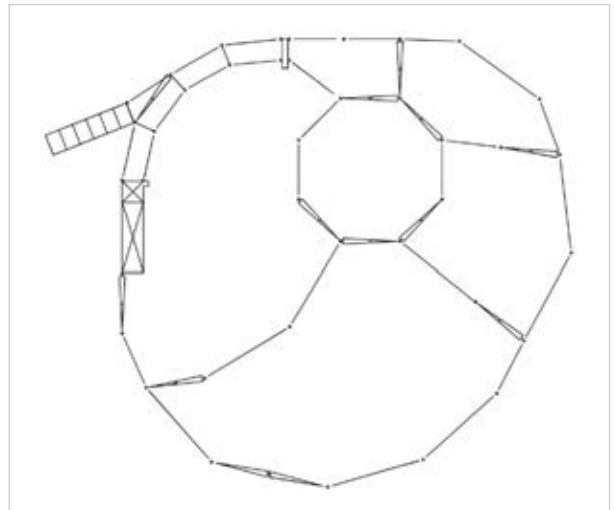

100 HEAD YARD

- 220m²
- 16.4m x 16.4m
- Weean yard design
- 5-way drafting pound
- Traditional force
- 3.5m loading ramp

Product Code: AFQ110

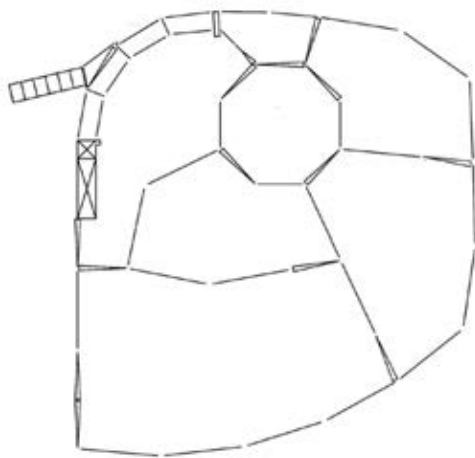

150 HEAD YARD

- 294m²
- 19.5m x 17.5m
- Weean yard design
- 5-way drafting pound
- Traditional force
- 2-way race draft
- 3.5m loading ramp

Product Code: AFQ147

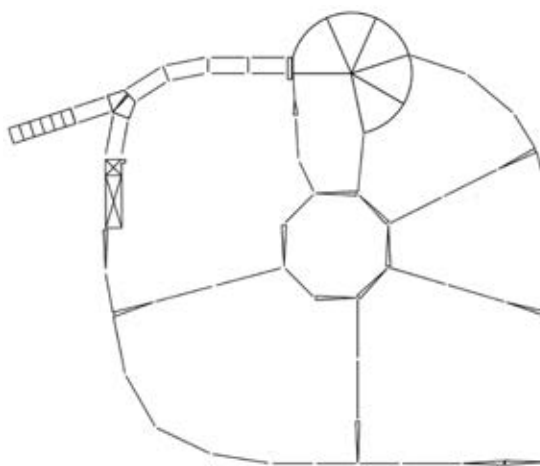

200 HEAD YARD

- 430m²
- 22.2m x 20.5m
- 6-way drafting pound
- Full BudFlow®
- Q-Gate
- 3.5m loading ramp

Product Code: AFQ215

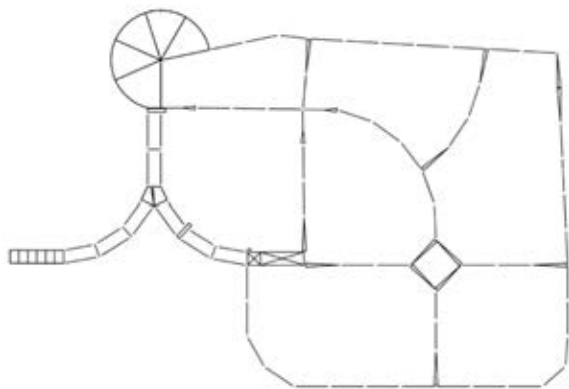

250 HEAD YARD

- 490m²
- 27.6m x 23m
- Diamond yard design
- Full BudFlow®
- Q-Gate
- 2-way race draft
- 3.5m loading ramp

Product Code: AFQ245

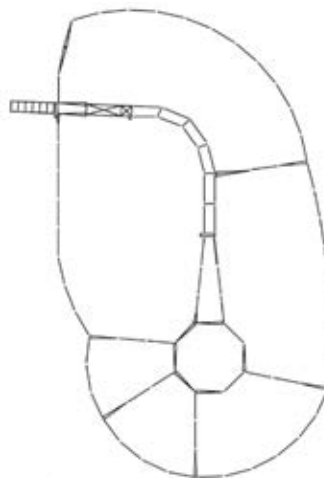

300 HEAD YARD

- 600 m²
- 35.7m x 20.7m
- Weean yard design
- 6-way drafting pound
- 3-way race draft
- 4.8m loading ramp

Product Code: AFQ300

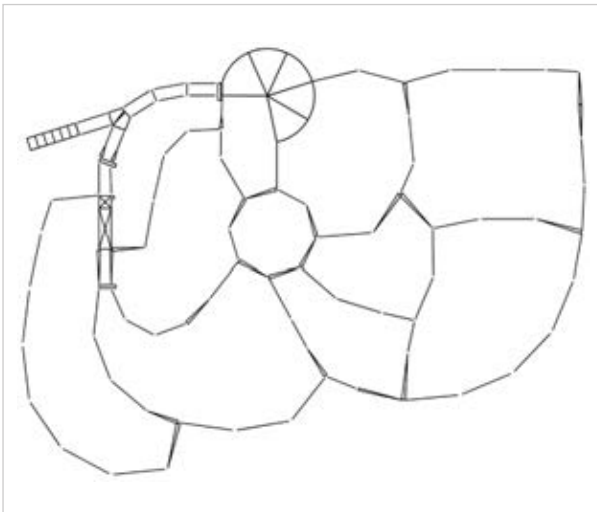

350 HEAD YARD

- 720m²
- 27.5m x 36.1m
- Bugle yard design
- Cattle-free area
- 6-way drafting pound
- Full BudFlow®
- Q-Gate
- 3-way race draft
- 3.5m loading ramp

Product Code: AFQ360

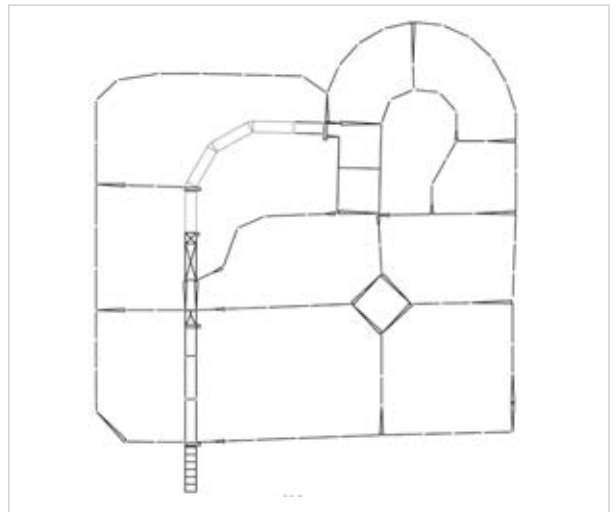

400 HEAD YARD

- 840m²
- 34.4m x 30.5m
- Diamond yard design
- Cattle-free zone
- Beef Buddy®
- 5-way race draft
- 4.8m loading ramp

Product Code: AFQ420

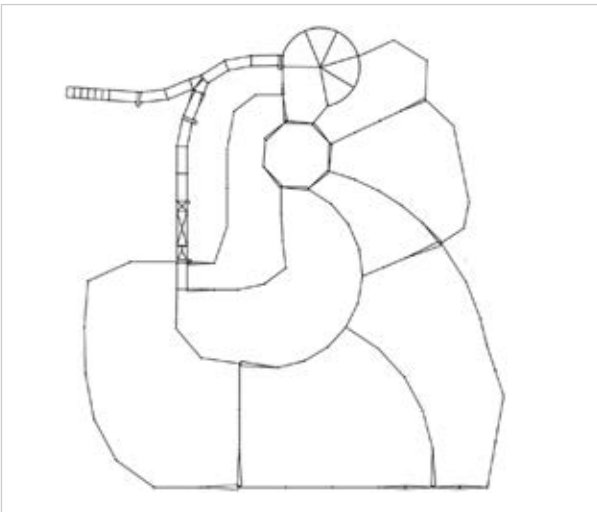

450 HEAD YARD

- 880m²
- 31.3m x 35.6m
- Bugle yard design
- Cattle-free zone
- 7-way drafting pound
- Full BudFlow®
- Q-Gate
- 3-way race draft
- Stockcare loading ramp

Product Code: AFQ440

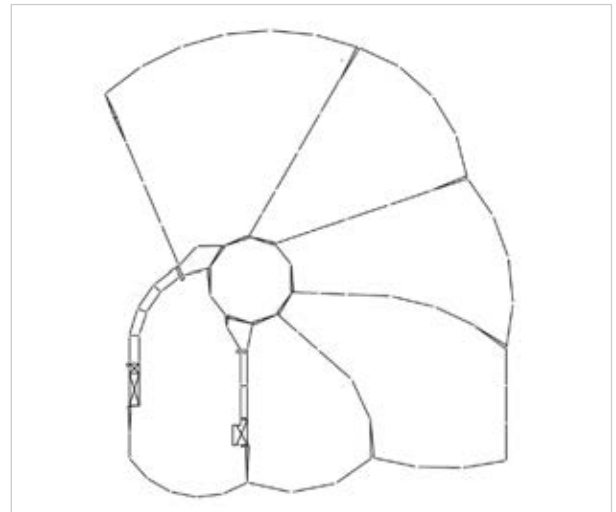

500 HEAD YARD

- 1002m²
- 46m x 41.5m
- Bugle yard design
- Calf management section with calf cradle
- 5-way drafting pound
- Full BudFlow®
- Q-Gate
- 4-way race draft
- Stockcare loading ramp

Product Code: AFQ501

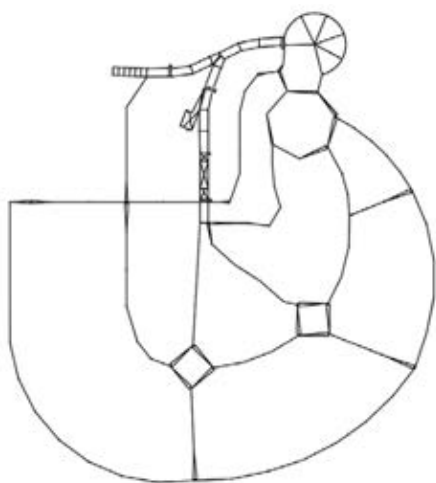

600 HEAD YARD

- 1200m²
- 46m x 41.5m
- Bugle design
- 5-way drafting pound
- Full BudFlow®
- Q-Gate
- 4-way race draft
- Stockcare loading ramp

Product Code: AFQ600

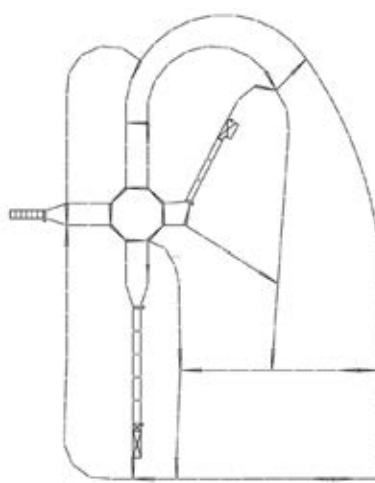

700 HEAD YARD

- 1360m²
- 46.4m x 31.6m
- Bugle yard design
- Calf management section with calf cradle
- 8-way drafting pound
- 4.8m loading ramp

Product Code: AFQ680

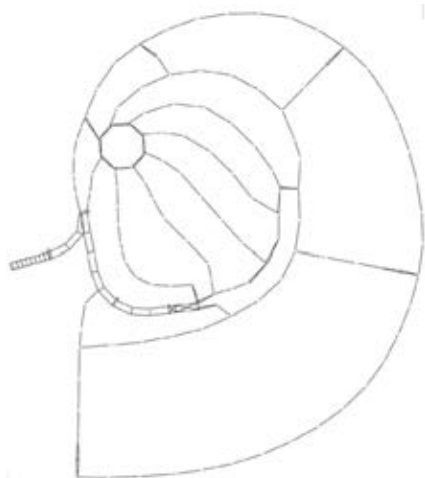

900 HEAD YARD

- 1800 m²
- 54.5m x 40.7m
- Bugle yard design
- 8-way drafting pound
- 3-way race draft
- Stockcare loading ramp

Product Code: AFQ900

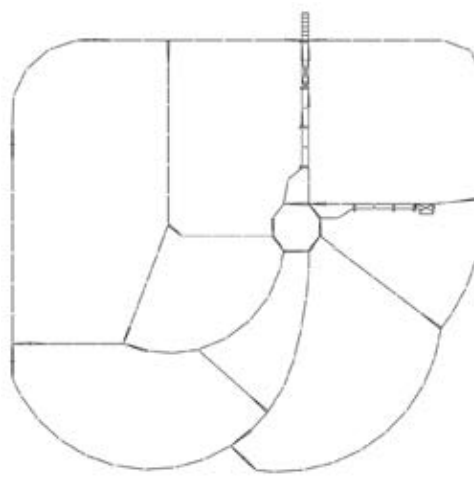

1000+ HEAD YARD

- 2718 m²
- 52.3m x 57.4m
- Bugle yard design
- Calf management section with calf cradle
- 7-way drafting pound
- Traditional force
- 3-way race draft
- Stockcare loading ramp

Product Code: AFQ1359

SEMI-PERMANENT STOCKYARDS

- Lug & Pin System ensures quick installation
- Freedom to add to your stockyard system at any time, or move the yard to a new property
- Modular system allows you to make changes and additions to your yard, as necessary
- Oval rails prevent cattle bruising
- Feet are secured to the ground with pins (Optional)



CAN BE INSTALLED WITH PERMANENT POSTS TO ADD STRENGTH TO YOUR SEMI-PERMANENT YARD SYSTEM.

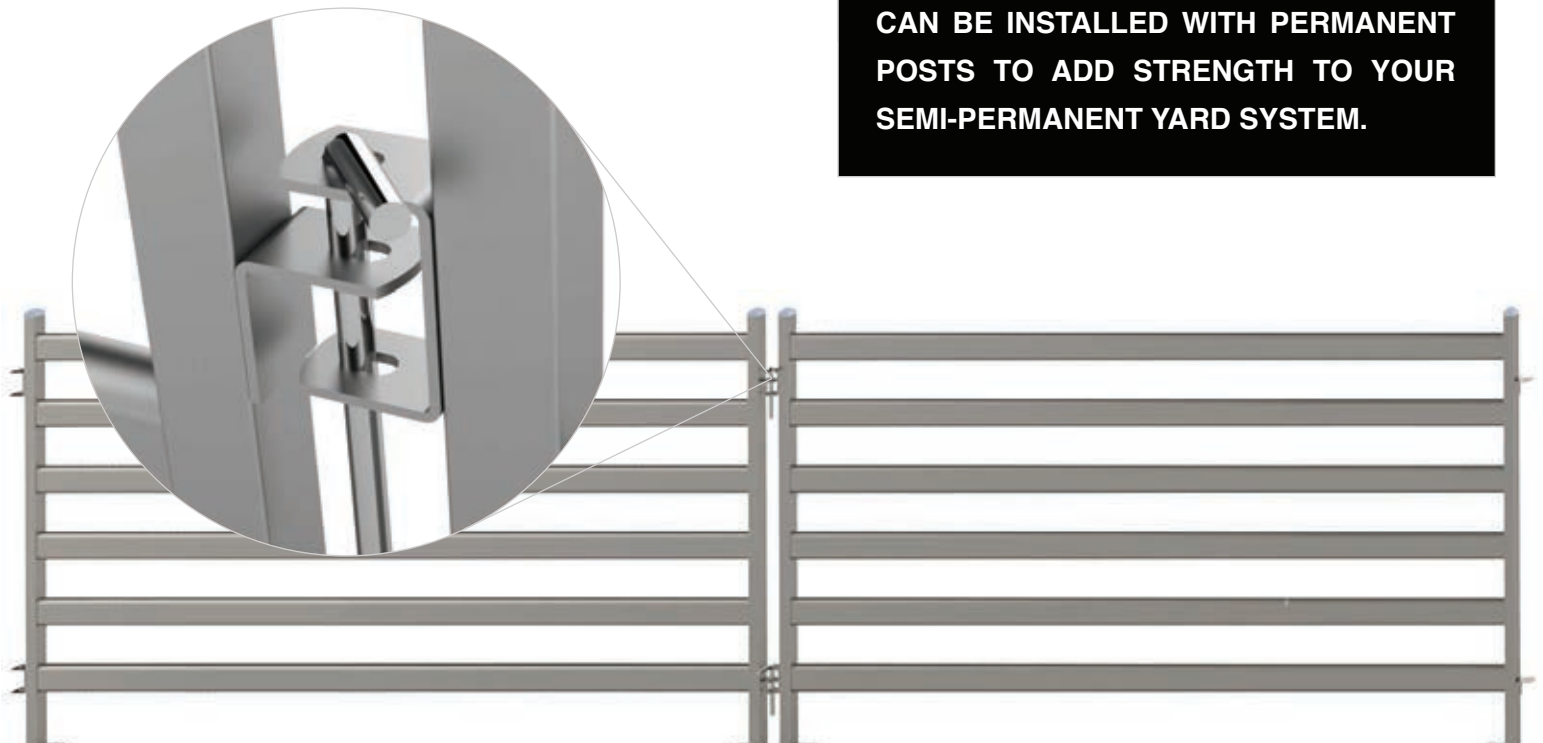



PERMANENT STOCKYARDS

- Posts are cemented
- Posts come in three sizes
 - 2.4m Panel Post
 - 2.9m Gate & Overhead Bracing Post
 - 3.6m High Bow Gate Post
- Post and clamp system provides maximum strength and ensures there is no rattling
- Quick and easy installation process
- Panels and gates of the same size can be interchanged, adding flexibility to your yard design

FLAGPOLE PERMANENT

Flagpole panel, welded on one end and clamped on the other.

FULLY PERMANENT

Individual panels and posts with clamps on both ends.

INSTALLATION DETAILS

- Yard is set up before holes are dug to ensure accuracy of placement of all posts and concrete pads
- Once holes are dug, the posts are cemented into the ground
- Panels and gates are connected to posts with heavy-duty clamps
- Minimal on-site welding required

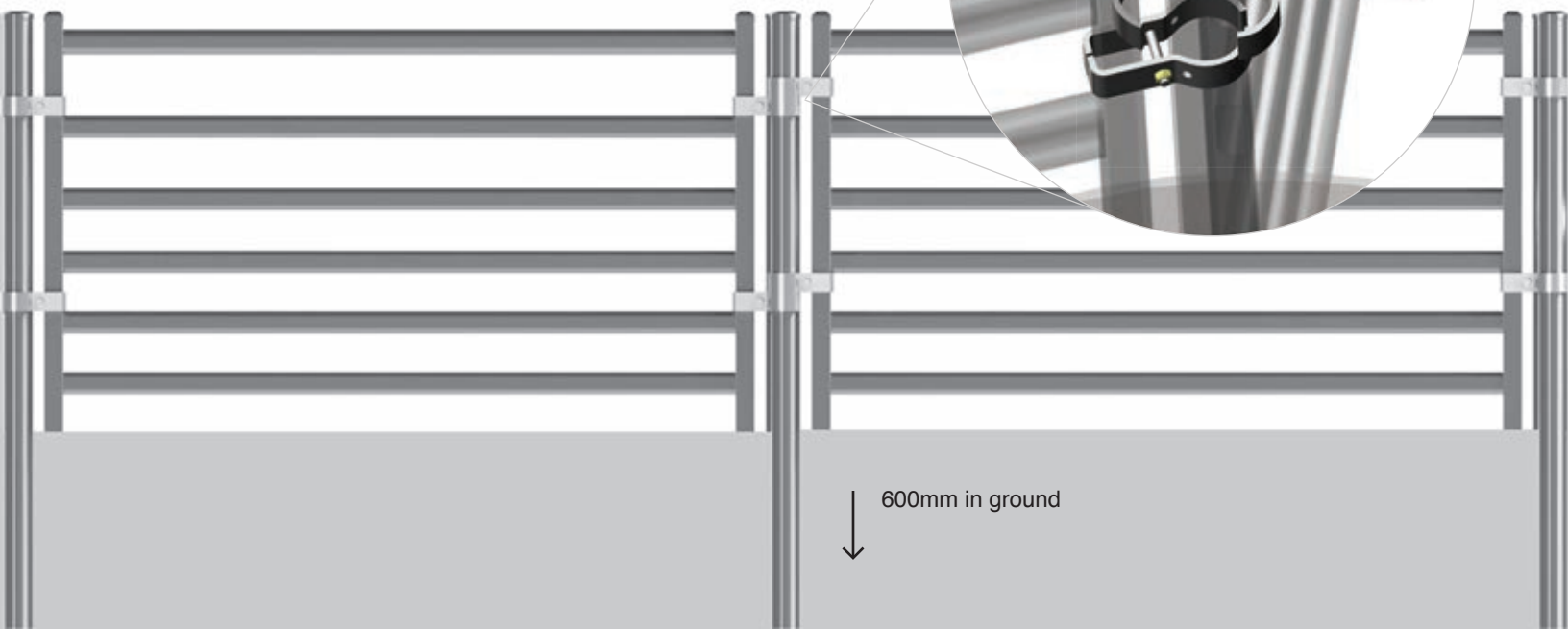
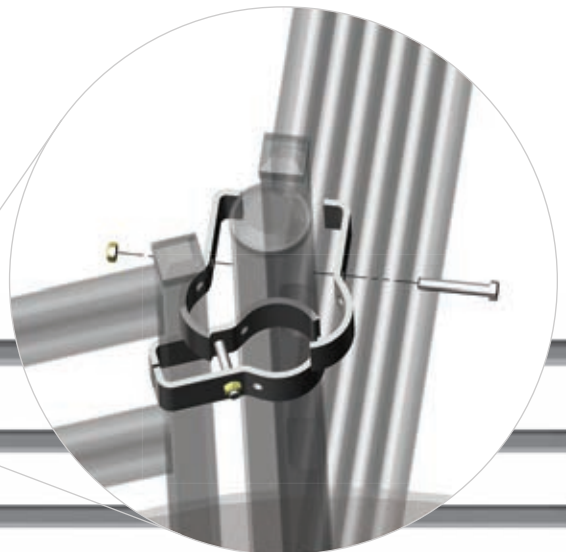

600mm in ground

RAIL COMPARISON

BEEF MAX

For ultimate visibility, durability, and minimum bruising, look no further than BEEF MAX. This premium line of cattle panels is an excellent option for high-pressure areas in the stockyard.

5-BAR: 1600mm high

6-BAR: 1800mm high

RAIL: 115mm x 42mm

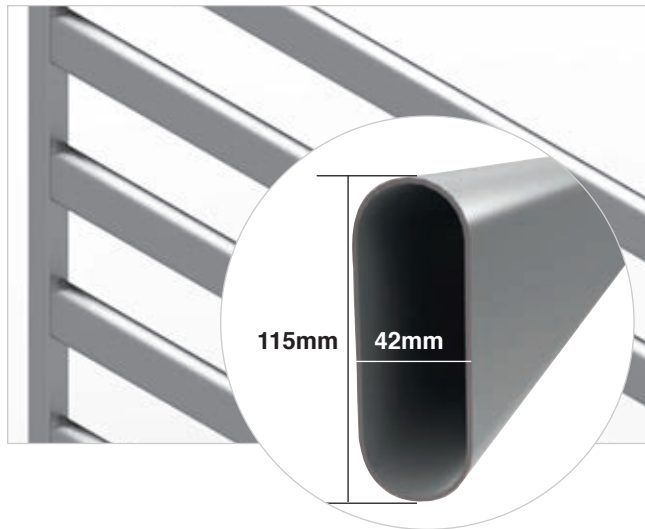

BEEF MAX Panels for permanent and semi-permanent installation are available in the following sizes:

1.8m Panel

3m Panel

2.1m Panel

3.6m Panel

BEEF MAX Gates for permanent and semi-permanent installation are available in the following sizes:

2.1m Gate

0.8m Man Gate

2.1m Gate with High Bow

0.8m Swing Race Gate

3m Gate

2.1m Man Gate in Panel
(Semi-Permanent Only)

4.2m Double Gate

XPE

XPE Panels are a high quality, extremely durable panels suitable for any property. This premium line of cattle panels is the exceptional all-rounder stockyard solution.

5-BAR: 1600mm high

6-BAR: 1800mm high

RAIL: 66mm x 44mm

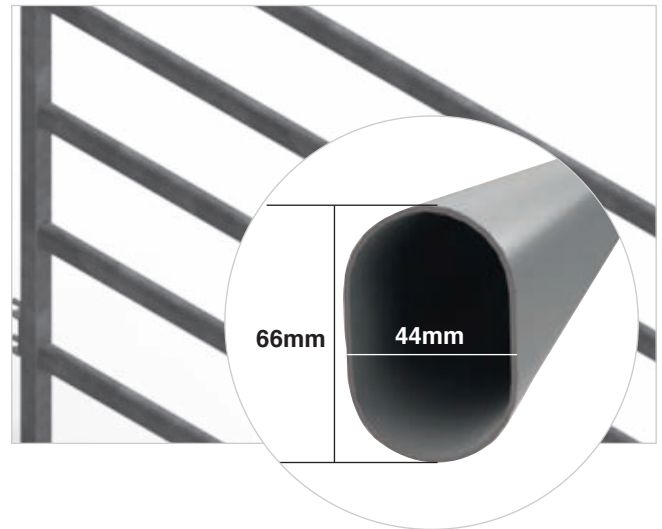

XPE Panels for permanent and semi-permanent installation are available in the following sizes:

1.8m Panel

3m Panel

2.1m Panel

3.6m Panel

XPE Gates for permanent and semi-permanent installation are available in the following sizes:

2.1m Gate

0.8m Man Gate

2.1m Gate with High Bow

0.8m Swing Race Gate

3m Gate

2.1m Man Gate in Panel
(Semi-Permanent Only)

4.2m Double Gate



Our unique gate hinge is fitted with nylon bushes for maintenance and rust-free operation, and offers a 300° swing that will never seize. The 4.2M Double Gates have a double hinge, and offer 360° range of motion.

COMBO RANGE PANELS

WORK CATTLE & SHEEP IN A SINGLE STOCKYARD

- 7 & 8-Bar Panels designed to work large and small animals in the same system
- Provides the height required for large livestock security and the narrow spacing for small animal safety
- Available with XPE rails

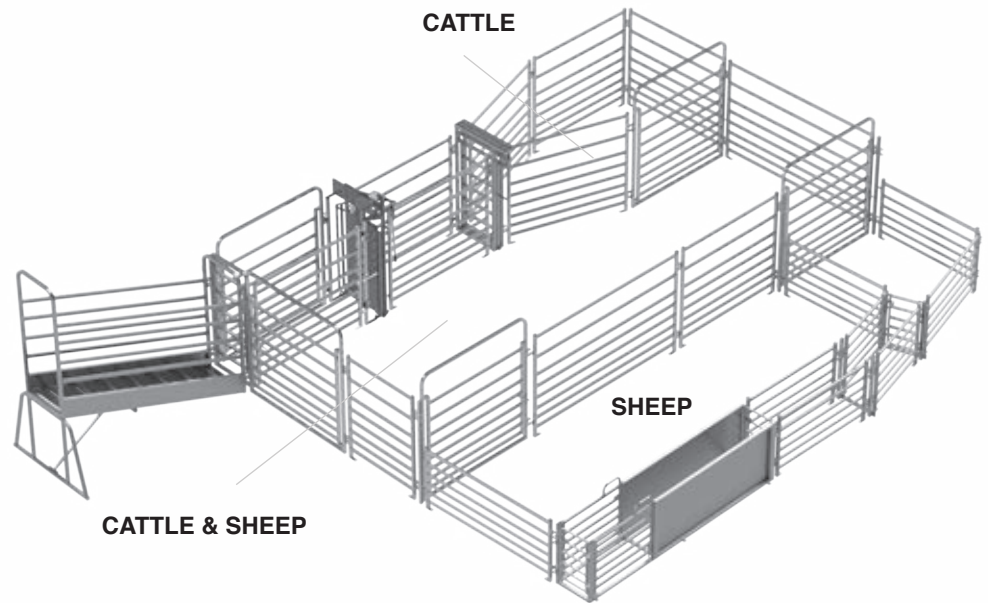

PORTABLE YARDS

TAKE YOUR YARDS TO THE CATTLE

- Includes the Q-Catch 86 Series Head Bail and portable cattle loading ramp
- All components load onto the ramp for easy transport
- 3.5m ramp with 600mm sheeting
- Available with XPE or BEEF MAX rails
- Lug & Pin System

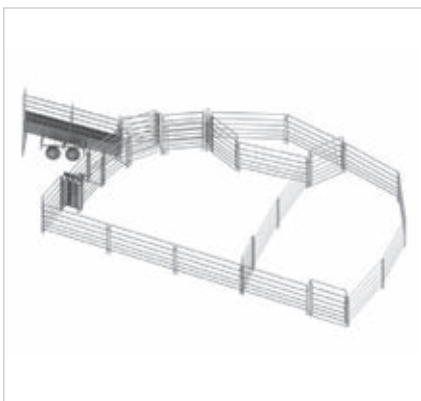



THE ARROWQUIP EXPERIENCE

CASE STUDY: ANDREW HARRIES, HARLEES LIMOUSINS

PROBLEM

- Working cattle was very time consuming
- Old system caused high stress levels for the animals
- High stress animals made management tasks difficult and dangerous to complete
- Processing calves was very time consuming, as it was difficult to contain them safely
- Crush was unreliable and did not hold livestock securely, making their AI program very challenging

SOLUTION

- Develop a system that would allow for the animals to flow easily throughout the system
- Use the flight zone of the animal effectively with limited stress
- Allow them to handle their largest and most difficult to work animals with ease
- Increase the efficiency of working cattle



TACTIC

- Arrowquip consulted with the producer one on one to discuss the issues they were facing
- Worked closely with the producer to develop the ideal solution for their unique needs and style of working cattle
- Discussed the impact of animal science and proper Stockmanship in managing livestock effectively
- Working with renowned stock handler Boyd Holden, Arrowquip created several designs that could provide a solution tailored to their needs
- Installed and tested the new yard design to ensure they have found the right solution for their specific operation

RESULT

- The new system has facilitated a massive time decrease
- New Q-Catch cattle crush is very smooth and quiet, ensuring they are not wound-up, stirred-up, or unnecessarily worried
- Q-Race system allows them to manage calves in a third of the time it took to process them previously, and has made it much easier to access them
- Allows Andrew to complete all handling operations by himself, as he is the sole worker on the property
- The new Q-Catch cattle crush with the double squeeze has made their AI program a much easier process
- The new facility offered the opportunity to improve their Stockmanship techniques and provide a less stressful environment for both the handlers and the animals



An aerial photograph of a large-scale commercial livestock stockyard. The facility is composed of numerous rectangular pens of varying sizes, some containing large groups of cattle. A long, straight race track runs along the top right side of the main pen area. In the bottom right foreground, there is a large, modern white building with a green roof, likely a processing or storage facility. The entire area is enclosed by metal fencing, and the ground is a mix of dirt and sparse grass. The background shows a flat landscape with some trees and a clear sky.

COMMERCIAL PRODUCERS

Arrowquip is dedicated to providing Commercial Livestock Producers with a complete range of services tailored specifically to their needs. Through many years of industry experience in the livestock sector in Australia and the Americas, and generations of personal experience working livestock, Arrowquip brings a wealth of knowledge to their stockyard system design services.





DESIGN AND PLANNING EXCELLENCE

Designing and planning livestock handling systems is one of the most important parts in the process of building new stockyards. There are a series of small, critical design details which must be considered to create optimal flow within your yard system. By placing the focus on animal science and livestock psychology, all designs created by Arrowquip are made to ensure you can work your livestock in the most effective and efficient manner possible.

Design and planning stages include:

INITIAL CONSULTATION

During this meeting, we will discuss your livestock operation, the animal husbandry tasks which you perform on a regular basis, and the issues you encounter which you would like to eliminate with your new yard system.

SITE ASSESSMENT

This includes mapping out the location and orientation of yards, laneway access, truck access, services, and accommodating existing infrastructure, if necessary.

DESIGN REVIEW

Based on the needs of your operation, our team will develop a design tailored for your property. Once the designs have been developed, we will review the designs and make any changes you would like to see.

BUDGET AND COST CONTROL

Once your design has been chosen, we will determine the best installation and specific product choices for your budget.

INDUSTRY EXPERTISE

A depth of knowledge surrounding livestock behaviour is at the core of each of our stockyard designs. By combining a wealth of knowledge in animal science with extensive real-world testing, we create stockyard systems and products that make handling your cattle faster, easier, and more effective.

WORLD-CLASS MANUFACTURING

World-class manufacturing is one of our primary focuses. Through a unique combination of product design, rationalization, and lean manufacturing processes, we provide our clients with a quality range of reliable products and systems.

PROJECT MANAGEMENT AND INSTALLATION

The Product Management and Installation process provides clients with peace of mind and that their system will be installed according to the established plan, and that all critical details are accounted for. With our Total Base Station and Drone technology, it is guaranteed that the yards will be installed precisely according to the plan, on time, and on budget.

Arrowquip can work with your local contractor or builder to ensure the yards are installed properly and in a timely manner.

